

An aerial photograph of a lush rooftop garden. A central glass pavilion with a white metal roof and dark frame is the focal point, where several people are gathered. A paved path leads from the pavilion through various raised garden beds filled with diverse plants, including leafy greens and flowers. String lights are strung across the garden. In the background, a building with a corrugated metal roof and a brick wall with vertical slats are visible.

Cultivating the Community Commons

Climate, Culture, Craft
Scanl | Design Master Studio 2015

TODAY'S SCHEDULE

1:30 - 2pm

Introductions

Nancy Rottle, Landscape Architecture

Jim Nicholls, Architecture

TA: Hailey Mackay, MLA

Context Presentation

Andrew Prindle, LArch

Emily Darling, Arch

2-2:10

Refreshments

Gallery Walk

2:10 - 4:50

Reviews

4:50 - 5:00

Wrap up

2015 Studio Schedule

September 4 - 20

Study Tour

Copenhagen + Samsø + Malmö
Helsingør

September 30

First Day of Class

Seattle
Living Community Challenge

September 30 - November 5

Copenhagen Precedents

Panel Discussion

Community Analysis

Conceptual Design

Schematic Design

November 6

(today)

Midterm Review

(here)

2015 Studio Schedule

September 4 - 20

Study Tour

Copenhagen + Samsø + Malmö
Helsingør

September 30

First Day of Class

Seattle
Living Community Challenge

September 30 - November 5

Copenhagen Precedents

Panel Discussion

Community Analysis

Conceptual Design

Schematic Design

November 6

(today)

Midterm Review

(here)

09/04 - 09/20

DENMARK

SWEDEN

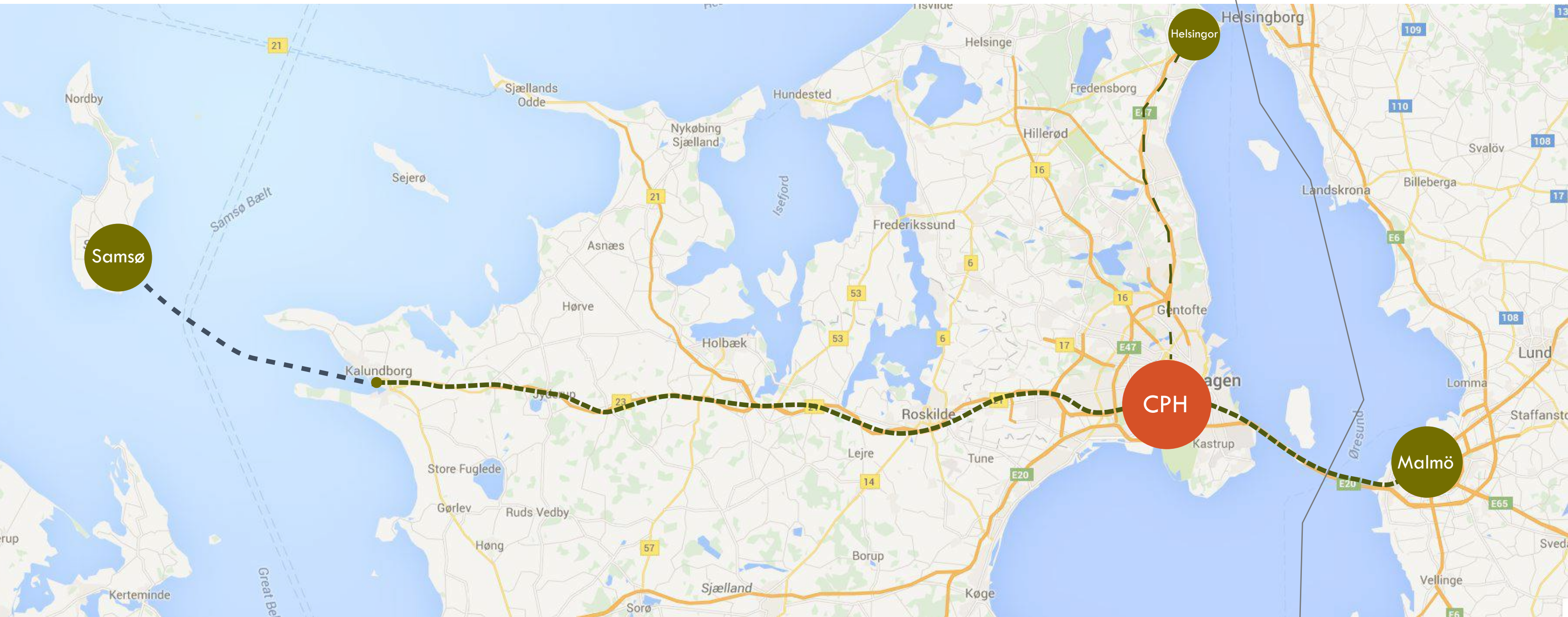



**Copenhagen + Samsø + Malmö
Helsingør**

Cycling



Office Visits



Site Tours



Instruction



Copenhagen + Samsø + Malmö Helsingør

Cycling

Copenhagen Left

Cycling in Heels

Cycling in Suits

Bikes on the Metro

Cycling with Coffee

Cycling in Style

Hand Signals

Grade-Separated Cycle Tracks

Dedicated Bike Lanes

Bicycle Right-of-Way

Bicycle Culture

Helmet or no Helmet?

Bicycle Bridges

Cargo Bikes

Bike Parking

Bike Racks





Copenhagen + Samsø + Malmö Helsingør

Cycling

Copenhagen Left

Cargo Bikes

Cycling in Heels

Cycling with Coffee

Cycling in Style

Hand Signals

Bicycle Bridges

Grade Separated Cycle Tracks

Dedicated Bike Lanes

Bicycle Right-of-Way

Bicycle Culture

Helmet or no Helmet?

Cykelslangen

Bike Parking

Bike Racks

Bikes on the Metro



Copenhagen + Samsø + Malmö
Helsingør

Office Visits

Tredje Natur

COBE

Gehl Architects

Schønherr

Energy Academy

City of Copenhagen



Culturo
Climate, Culture and



Copenhagen + Samsø + Malmö Helsingør

Site Tours

Bo01, Malmö Harbor Tour

Pildammsparken

Cykelkoket/STPLN

Louisiana Museum, Humlebæk

Prismen Sports Center

Kvarterhuset

ØsterGro

Christiania

Vennelyst Allotment Garden

Östra kyrkogården

Superkilen

Maritime Youth House

Amager Children's House

Banana Park

Energy Academy

Sydhavn I Skolen

Amager Strandpark





Copenhagen + Samsø + Malmö Helsingør

Site Tours

Bo01, Malmö Harbor Tour

Pildammsparken

Cykelkoket/STPLN

Louisiana Museum, Humlebæk

Prismen Sports Center

Kvarterhuset

ØsterGro

Christiania

Vennelyst Allotment Garden

Östra kyrkogården

Superkilen

Maritime Youth House

Amager Children's House

Gammel Hellerup Gymnasium

Energy Academy

Sydhavn I Skolen

Amager Strandpark



Copenhagen + Samsø + Malmö Helsingør

Site Tours

Bo01, Malmö Harbor Tour

Pildammsparken

Cykelkoket/STPLN

Louisiana Museum, Humlebæk

Prismen Sports Center

Kvarterhuset

ØsterGro

Christiania

Vennelyst Allotment Garden

Östra kyrkogården

Superkilen

Maritime Youth House

Amager Children's House

Gammel Hellerup Gymnasium

Energy Academy

Sydhavn I Skolen

Amager Strandpark





**Copenhagen + Samsø + Malmö
Helsingør**

Instruction

Bianca Hermanson, Cititek

**Lars Gemzoe, Gehl Architects
Birgitte Svarre, Gehl Architects**



**Mikkel de Vries Bækgaard,
City of CPH, Bicycle Planning
Lykke Leonardsen,
City of CPH, Climate Adaptation**



**Jesper Roug, Energy Academy
Soren Hermansen, Energy Academy**

Catarina Rolfsdotter-Jansson, Bo01



Community

2015 Studio Schedule

September 4 - 20

Study Tour

Copenhagen + Samsø + Malmö
Helsingør

September 30

First Day of Class

Seattle
Living Community Challenge

September 30 - November 5

Copenhagen Precedents

Panel Discussion

Community Analysis

Conceptual Design

Schematic Design

November 6

(today)

Midterm Review

(here)

CULTIVATING THE COMMUNITY COMMONS: Climate, Culture, Craft



2015 Studio Objectives

explore strategies for creating
resilient and equitable public space

through engaging
such challenges and
opportunities as
urban intensification,
affordability,
cultural connections,
community diversity,
climate change adaptation
and food security

LIVING COMMUNITY CHALLENGE

The Living Community Challenge is comprised of seven performance areas, or “Petals”: Place, Water, Energy, Health + Happiness, Materials, Equity, and Beauty. Petals are subdivided into a total of twenty Imperatives, each of which focuses on a specific sphere of influence.

<http://living-future.org/lcc>

We use the Living Community Challenge rubric to structure and inform our designs, considering the 7 petals as essential guides.

PETALS & IMPERATIVES

PLACE

- 01. Limits to Growth
- 02. Urban Agriculture
- 03. Habitat Exchange
- 04. Human Powered Living



MATERIALS

- 11. Living Materials Plan
- 12. Embodied Carbon Footprint
- 13. Net Positive Waste



WATER

- 05. Net Positive Water



EQUITY

- 14. Human Scale + Humane Places
- 15. Universal Access to Nature & Place
- 16. Universal Access to Community Services
- 17. Equitable Investment
- 18. Just Organizations



ENERGY

- 06. Net Positive Energy



HEALTH & HAPPINESS

- 07. Civilized Environment
- 08. Healthy Neighborhood Design
- 09. Biophilic Environment
- 10. Resilient Community Connections



BEAUTY

- 19. Beauty + Spirit
- 20. Inspiration + Education

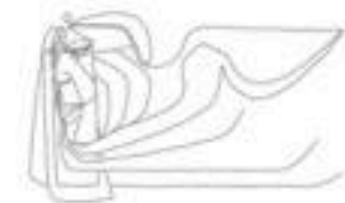

2015 Studio Schedule

September 4 - 20

Study Tour

Copenhagen + Samsø + Malmö
Helsingør

September 30

First Day of Class

Seattle
Living Community Challenge

September 30 - November 5

Copenhagen Precedents

Panel Discussion

Community Analysis

Conceptual Design

Schematic Design

November 6

(today)

Midterm Review

(here)



Guldborg Byplads

Copenhagen Precedents

Children's Culture House
Red Corner Day Care Center
Skolen I Sydhavn
Gammel Hellerup Gymnasium
Superkilen
Biblioteket
Bornings Independent School
Maritime Youth Center
Forfatterhuset Kindergarten
Prismen Sports Center
Kvarterhuset
Guldborg Byplads
Sønder Boulevard
Kalvebod Bølge
Sankt Kjelds Kvarter
Israels Plads

Copenhagen Precedents

Children's Culture House

Red Corner Day Care Center

Skolen I Sydhavn

Gammel Hellerup Gymnasium

Superkilen

Biblioteket

Bornings Independent School

Maritime Youth Center

Forfatterhuset Kindergarten

Prismen Sports Center

Kvarterhuset

Guldberg Byplads

Sønder Boulevard

Kalvebod Bølge

Sankt Kjelds Kvarter

Israels Plads

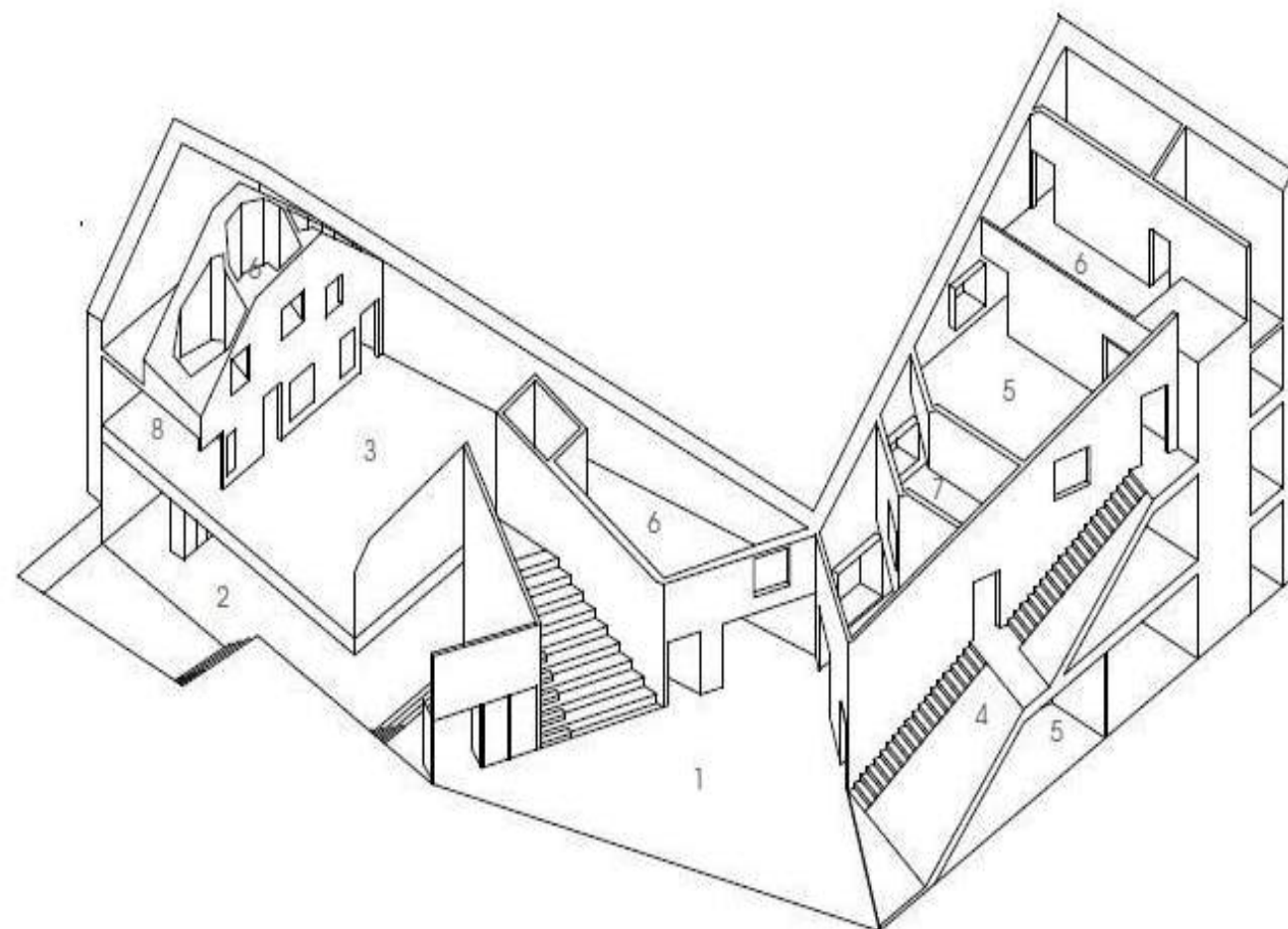

1. the plaza
2. multipurpose space / theatre
3. the café
4. mountain climbing
5. work shops
6. mezzanine
7. dance studio
8. administration



Copenhagen Precedents

- Red Corner Day Care Center
- Skolen I Sydhavn
- Gammel Hellerup Gymnasium
- Superkilen
- Biblioteket
- Bornings Independent School
- Maritime Youth Center
- Forfatterhuset Kindergarten
- Prismen Sports Center
- Sankt Kjelds Kvarter**
- Kvarterhuset
- Guldberg Byplads
- Sønder Boulevard
- Kalvebod Bølge
- Israels Plads
- Children's Culture House

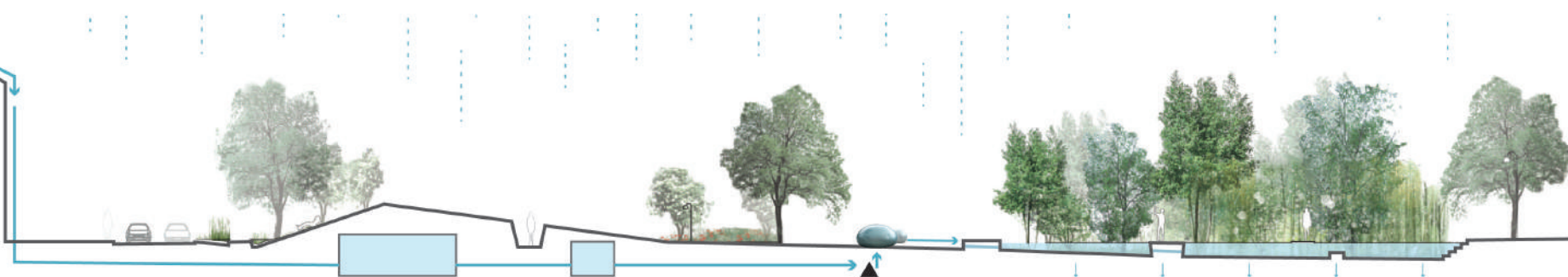



Copenhagen Precedents

- Red Corner Day Care Center
- Skolen I Sydhavn
- Gammel Hellerup Gymnasium
- Superkilen
- Biblioteket
- Bornings Independent School
- Maritime Youth Center
- Forfatterhuset Kindergarten
- Prismen Sports Center
- Kvarterhuset
- Guldborg Byplads**
- Sønder Boulevard
- Kalvebod Bølge
- Sankt Kjelds Kvarter
- Israels Plads
- Children's Culture House

SITE

Bullitt Center

SITE

Living Community Challenge
Focus Area

12th Ave + Yesler Way



SITE

First Hill

Seattle University

Juvenile Detention Center

SITE

Squire Park

Yesler Terrace

Bailey Gatzert Elementary

Little Saigon

Chinatown International District

12th Ave + Yesler Way

SITE

King County Archives
Ethiopian Restaurant
Vacant Industrial
Car Detailer



12th Ave + Yesler Way

SITE



southwest corner - looking north

SITE



north edge - looking south

SITE



east of site - looking west

SITE

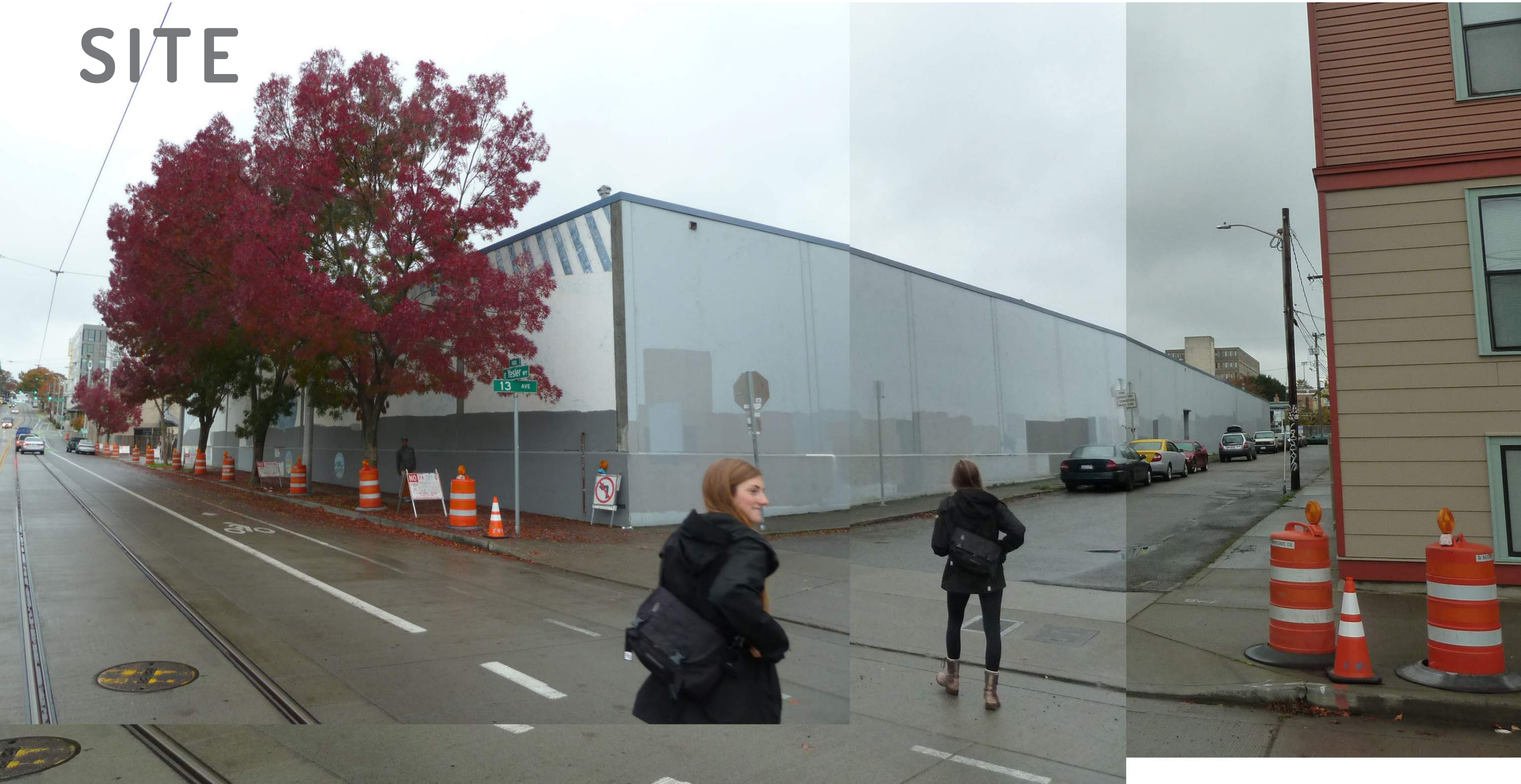

southeast corner - looking northwest

SITE



south edge - looking northeast



PANEL DISCUSSION

Darby Watson, Seattle Department of Transportation
Mark Hinshaw, Seattle Housing Authority
Rick Quirindongo, DLR Group
Quynh Pham, Seattle Chinatown International District Preservation
Adam Paul Amrhein, Living Community Challenge

COMMUNITY ANALYSIS

COMMUNITY SERVICES



CULTURE

- Central District Forum for Art and Ideas
- Densho: The Japanese American Legacy Project
- Jaam Rek Studio
- Japanese Cultural and Community Center
- Langston Hughes Performing Arts Institute
- Pratt Fine Arts Institute

YOUTH SERVICES

- 4C Coalition
- Aridell Mitchell Home
- Juvenile Justice Assessment Team

MINORITY SUPPORT

- Casa Latina
- Urban League
- Vietnamese Friendship Association

BUSINESS SUPPORT

- Community Capital Development
- The Melding Pot

POLITICAL ADVOCACY

- King County Coalition Against Domestic Violence
- Washington Community Action Network

GATHERING SPACE

- Lake Chad Cafe
- Seattle Buddhist Church

HOMELESS POPULATION

- Operation Nightwatch

NEIGHBORHOOD SAFETY

- Seattle Neighborhood Group

ENVIRONMENTAL

- Student Conservation Association

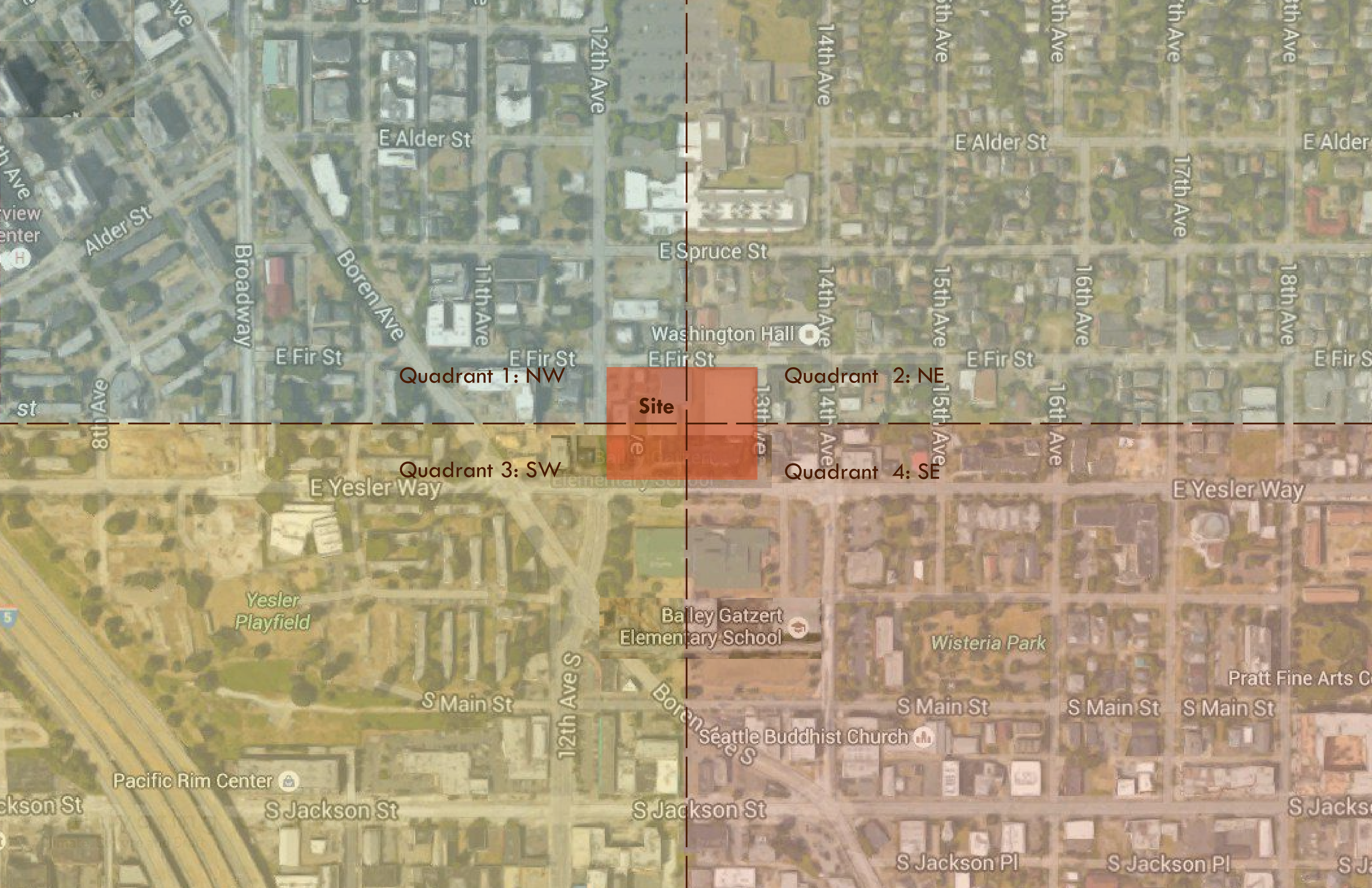

Site

Quadrant 1: NW

Quadrant 2: NE

Quadrant 3: SW

Quadrant 4: SE

Bailey Gatzert Elementary School

Wisteria Park

Seattle Buddhist Church

Yesler Playfield

Pacific Rim Center

S Jackson St

S Jackson St

S Jackson Pl

S Jackson Pl

S Jackson St

S Jackson Pl

Pratt Fine Arts Center

Boren Ave S

12th Ave S

S Main St

S Main St

S Main St

S Main St

12th Ave

14th Ave

15th Ave

16th Ave

17th Ave

18th Ave

E Alder St

E Alder St

E Alder St

E Spruce St

E Fir St

E Fir St

E Fir St

E Fir St

E Fir St

E Yesler Way

E Yesler Way

Alder St

Boren Ave

Broadway

8th Ave

st

5

Jackson St

0

Northwest Quadrant

First Hill - Seattle University - Horiruchi Park

DEMOGRAPHICS

34%

LANGUAGE OTHER THAN ENGLISH
SPOKEN AT HOME

41.3%

PEOPLE LIVING BELOW THE POVERTY
LEVEL IN THE NEIGHBORHOOD
(VERSUS 13.5% FOR KING CO
AND A 15% NATIONAL AVERAGE)

8.7%

UNEMPLOYMENT IN THE
SURROUNDING NEIGHBORHOODS
(VERSUS 6.9% FOR SEATTLE)

\$36,912

MEDIAN HOUSEHOLD INCOME FOR
THE NEIGHBORHOOD
(VERSUS \$71,811 FOR KING CO)

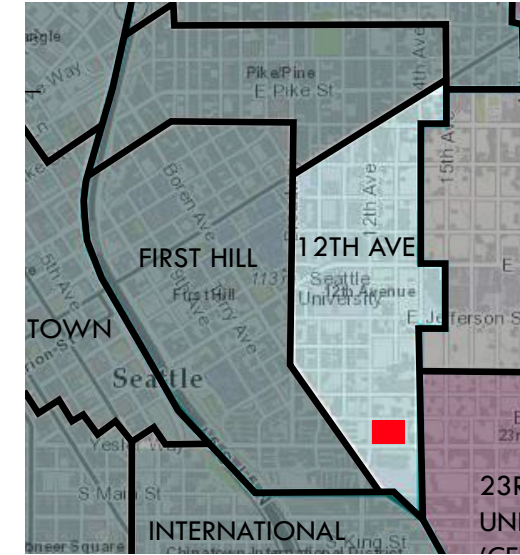
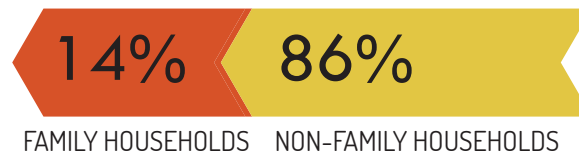

SITE

Source: 2010 US Census

POPULATION: 4,519
AREA: 0.2 sq miles
MEDIAN AGE: 30.6

RACIAL COMPOSITION

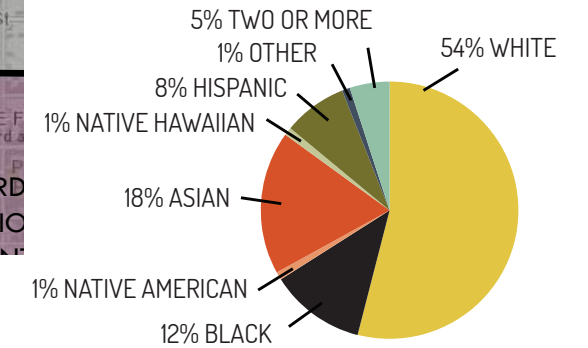

2010 US Census, 2013 American Community Survey

Homeless Students, King County (2007-08 to 2012-13 school years)

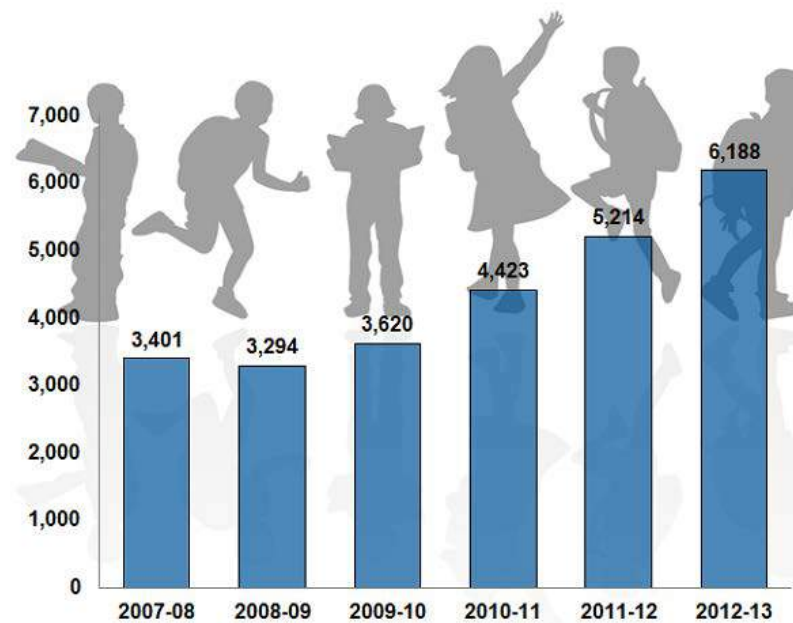

Data Source: Washington State Office of Superintendent of Public Instruction

COMMUNITIES COUNT, 6/14

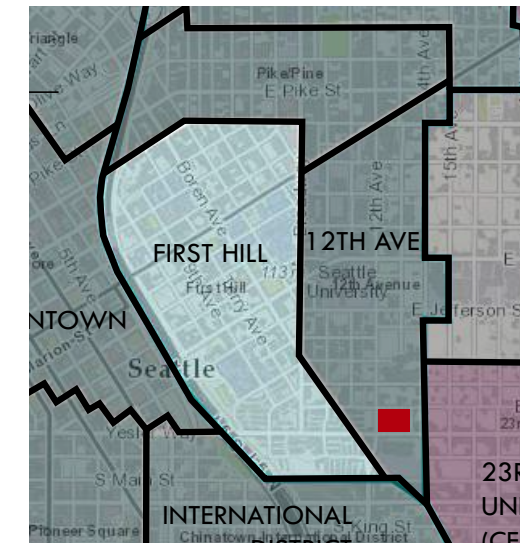
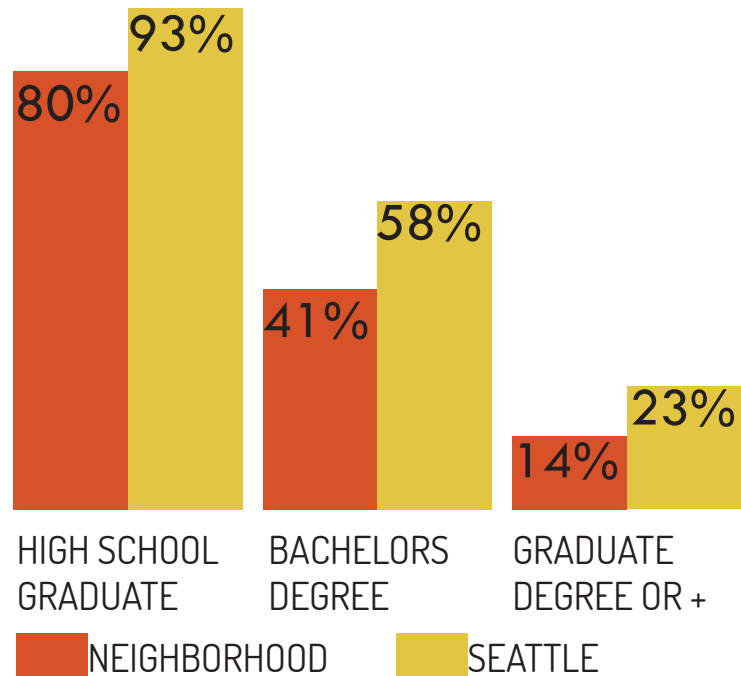

SITE

Source: 2010 US Census

POPULATION: 8,861
AREA: 0.4 sq miles
MEDIAN AGE: 42.6

RACIAL COMPOSITION

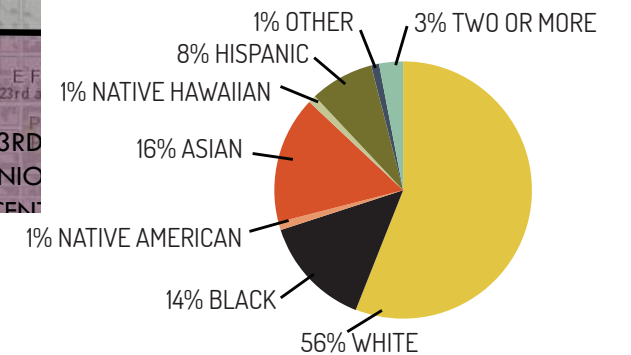

Northeast Quadrant

Squire Park - Juvenile Detention Center - P-Patch

NET ENERGY + WATER

NE Quadrant = 0.11 mi²
= 2,064.1 people

⚡ 34.7 kWh / day / person
25,784,737.2 kWh / year

💧 52 gallons / day / person
39,176,618 gallons / year

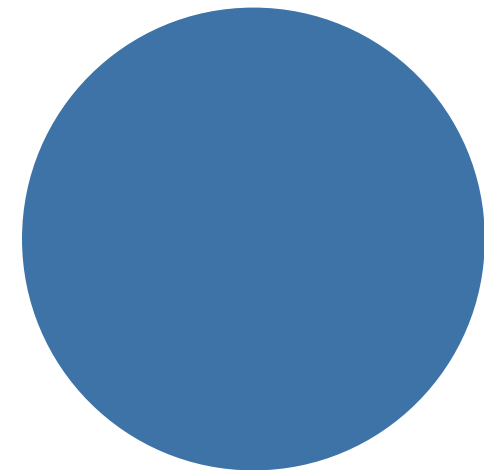
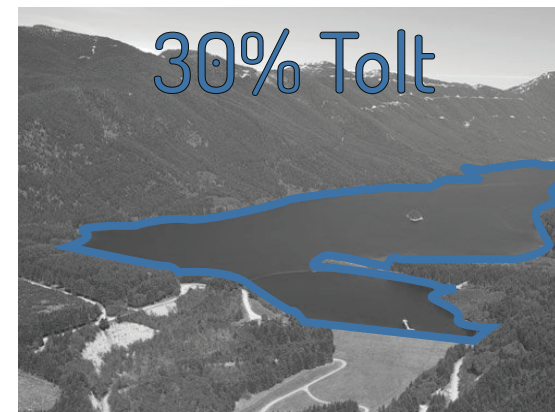
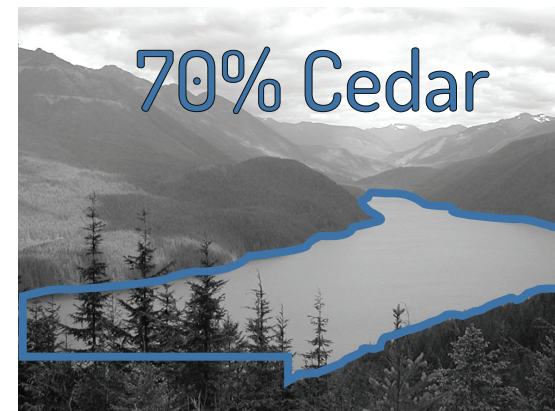
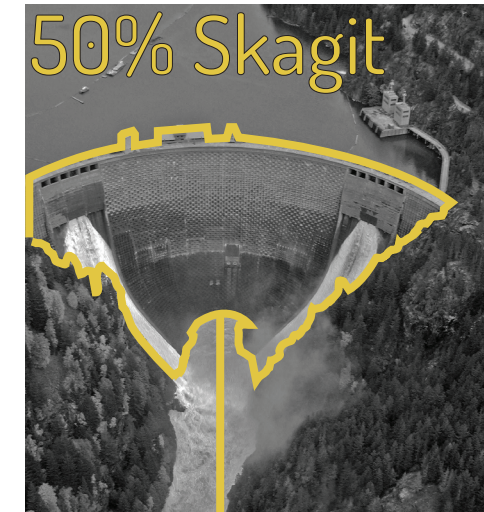
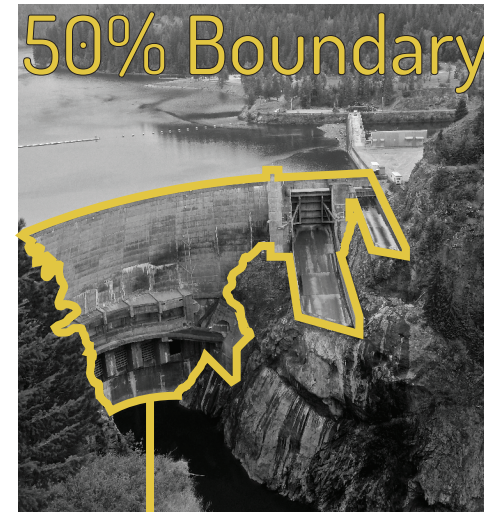

100% - watershed sourced H₂O

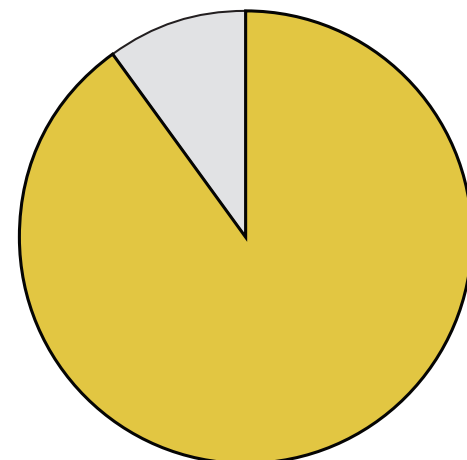

90% - hydropower

Southwest Quadrant

Yesler Terrace - Little Saigon - Chinatown International District

ARTS + CULTURE



NATURE. CULTURE. ART. Murals grace many of the building walls and illustrate the community's appreciation of and love of nature.

- Site
- Building
- Structure built before 1920
- Seattle Historic Landmark
- Church
- School (Public, Private, Beauty, Art, Martial Arts)
- Community Center
- Wellness Centers (Clinics, Massage, Acupuncture, Herbs)
- Public Art

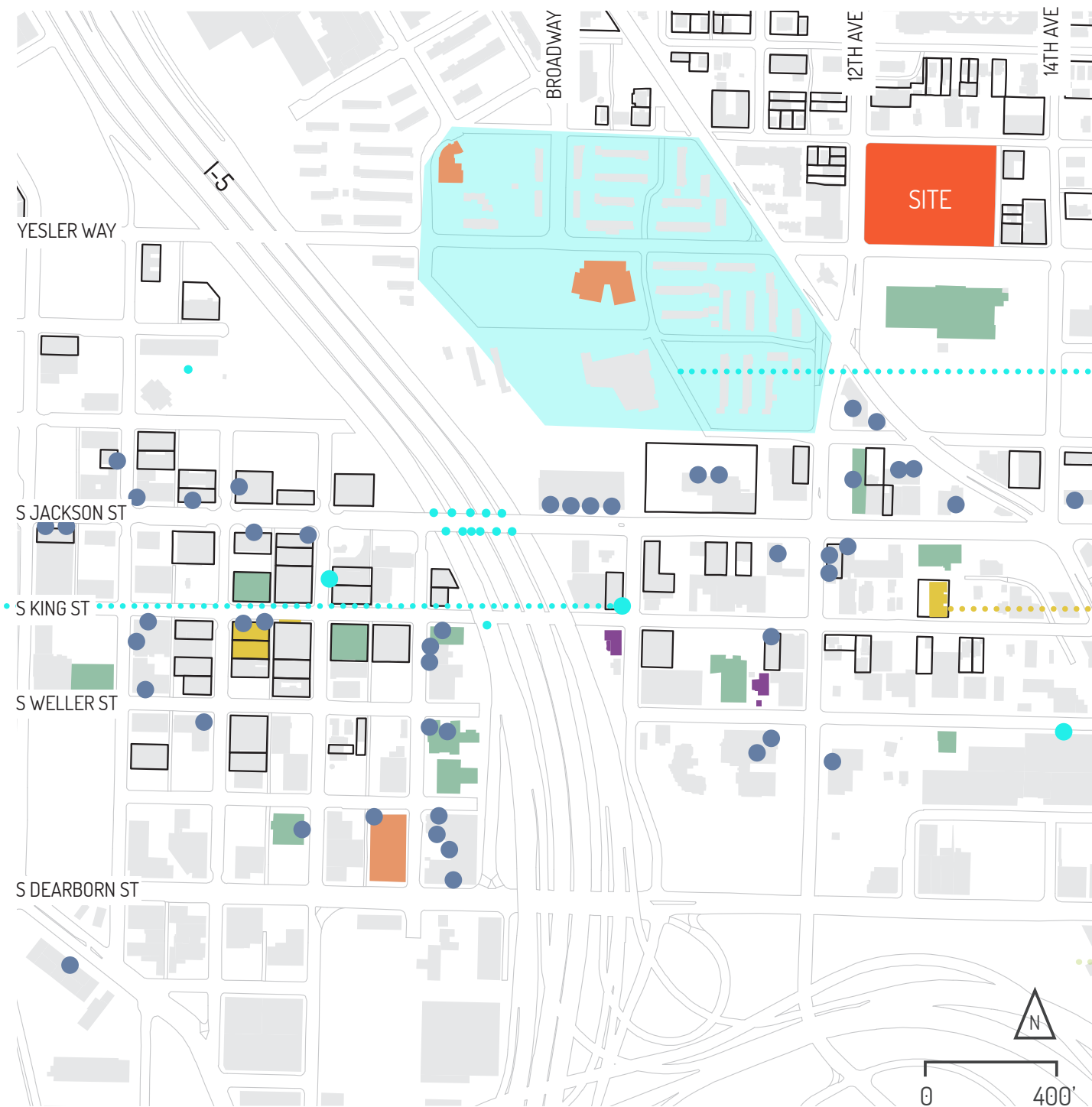

ARTS ON THE GROW. The SHA's Resident Artist program plans to house and assist artist's in the production of public artworks. The path surrounding the campus will contain art that is integrated directly into the pathways, seating, and garden features of the neighborhood. Career assistance for artists and craftspeople is also a target goal of the new development.



PRESERVING HISTORY. Almost demolished, this Victorian-style apartment building from the 1900's now serves families that are 30 - 60% median income. Little Saigon faces an uphill battle preserving these spaces in the wake of encroaching new development.

Southeast Quadrant

Bailey Gatzert Elementary - Little Saigon - Rainier Valley

HISTORY

1851 - Denny Party Lands at Alki

1855 - 1865 - Native American exclusion ordinance

1865 - Chinese Exclusion Act

1882 - Chinese Exclusion Act

1886 - The Seattle Riot

1895 - Seattle Japanese Language School is founded

1902 - Seattle Japanese Language School is founded

1905 - Chevra Bikur Cholim Synagogue completed

1908 - Jackson Street Regrade

1915 - The Entertainers Club opens

1920 - The Entertainers Club opens

1925 - Seattle Buddhist Church is dedicated

1935 - Yestler Terrace, Housing Project opens

1941 - Yestler Terrace, Housing Project opens

1944 - Japanese bomb Pearl Harbor

1945 - Japanese bomb Pearl Harbor

1948 - Ray Charles arrives on Jackson Street

1955 - Japanese citizens and anyone of Japanese ancestry ordered to "evacuate" Seattle

1974 - Chevra Bikur Cholim Synagogue is re-dedicated the Langston Hughes Cultural Arts Center

1976 - Pratt Fine Art Center is founded

1978 - Pratt Fine Art Center is founded

2003 - Japanese Cultural and Community Center opens

2009 - Casa Latina, moves headquarters to 17th and Jackson

2013 - "revitalization" of Yestler Terrace begins

2015



CONCEPTUAL DESIGN



NAPKIN SKETCHES



RESILIENCY THROUGH REDUNDANCY // RESILIENCY THROUGH ACTION // RESILIENCY OF IMAGINATION
 RESILIENCY OF SPIRIT // RESILIENCY OF RESIDENTS // RESILIENCY OF STRUCTURE // RESILIENCY
 RESILIENCY OF MATERIALS // RESILIENCY OF THE ARTS // RESILIENCY THROUGH CHILDREN // RESILIENCY
 RESILIENCY THROUGH ECONOMIC DEVELOPMENT // RESILIENCY THROUGH DESIRES // RESILIENCY
 RESILIENCY THROUGH COLLABORATION // RESILIENCY OF CLIMATE // RESILIENCY THROUGH EDUCATION
 RESILIENCY OF CULTURE // RESILIENCY THROUGH PERCEPTION // RESILIENCY THROUGH INNOVATION
 RESILIENCY OF LANGUAGE // RESILIENCY THROUGH ANALYSIS // RESILIENCY THROUGH FICTION
 RESILIENCY THROUGH SERVICE // RESILIENCY THROUGH LISTENING // RESILIENCY THROUGH GROWTH
 RESILIENCY OF ENGAGEMENT // RESILIENCY THROUGH PARTNERSHIPS // RESILIENCY THROUGH PAIN
 RESILIENCY THROUGH RETENTION // RESILIENCY THROUGH TRANSITION // RESILIENCY OF SENIORS
 RESILIENCY BY LEVERAGE // RESILIENCY THROUGH ADAPTABILITY // RESILIENCY THROUGH POPULARITY
 RESILIENCY THROUGH EDITING // RESILIENCY OF RULES // RESILIENCY OF HISTORY // RESILIENCY
 RESILIENCY OF THE FUTURE // RESILIENCY OF CAPACITY // RESILIENCY THROUGH CONNECTIVITY
 RESILIENCY THROUGH INCLUSION // RESILIENCY OF STANDING // RESILIENCY THROUGH CONTEXT
 RESILIENCY THROUGH CELEBRATION // RESILIENCY OF HUMAN NEED // RESILIENCY THROUGH LEADERSHIP
 RESILIENCY OF COMMUNITY // RESILIENCY THROUGH INTERNALIZATION // RESILIENCY OF LOYALTY
 RESILIENCY OF THE MIND // RESILIENCY OF INTEGRATION // RESILIENCY THROUGH STORYTELLING // RESILIENCY

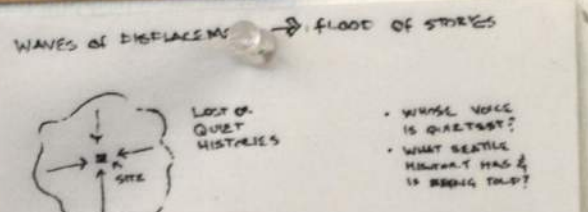
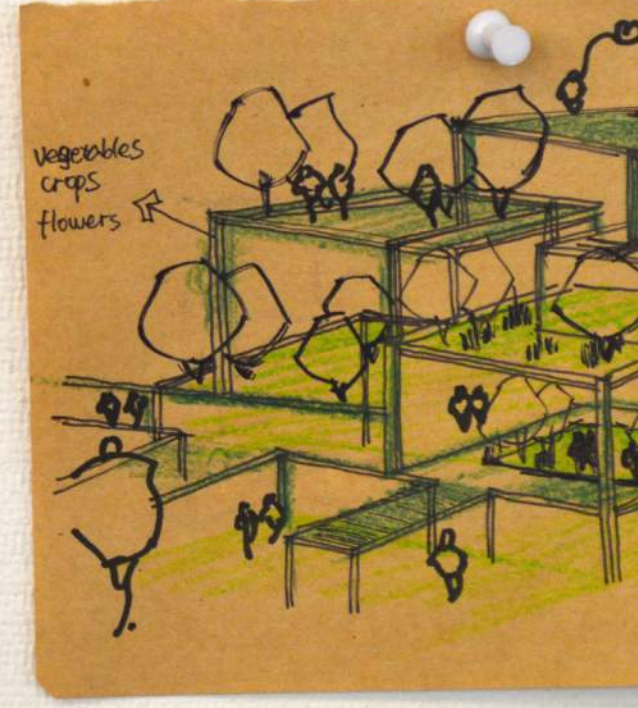
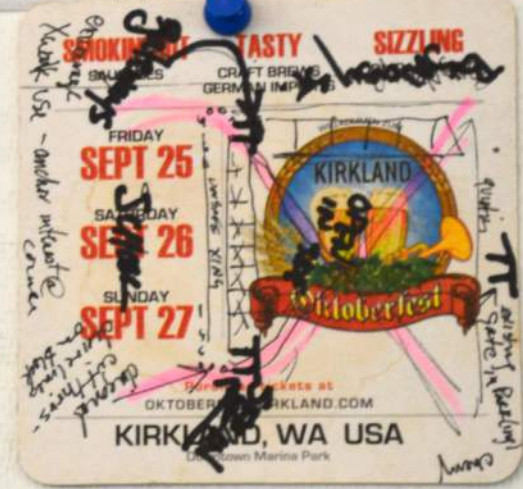
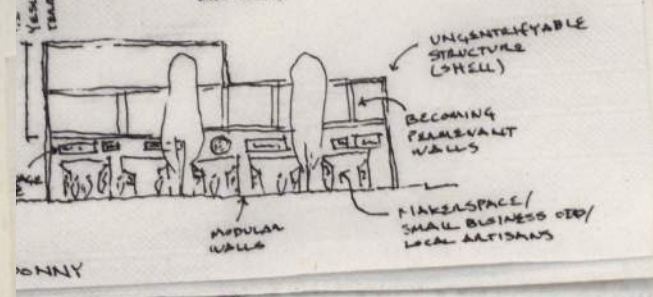

RK

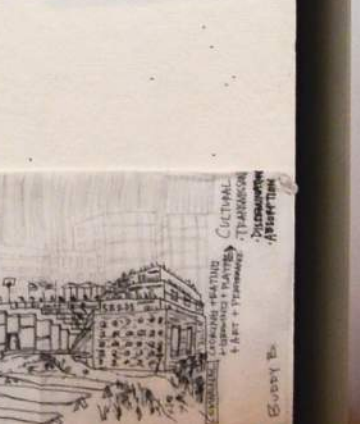
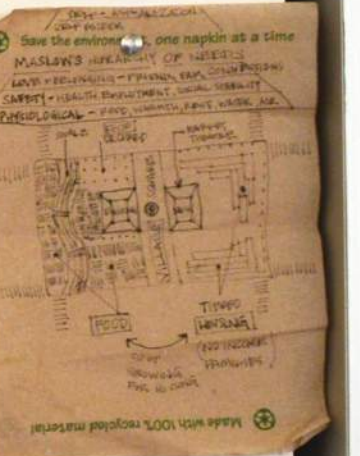
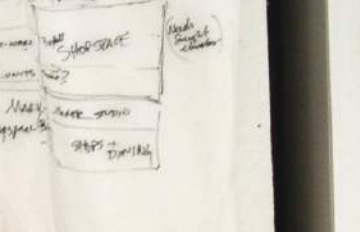
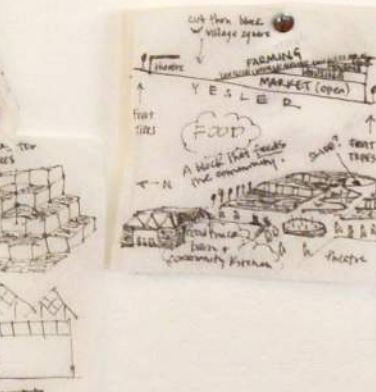
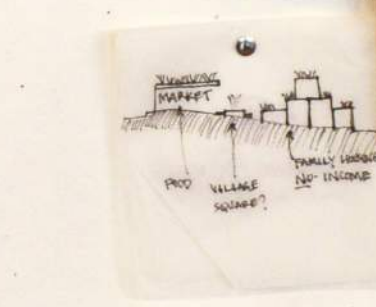
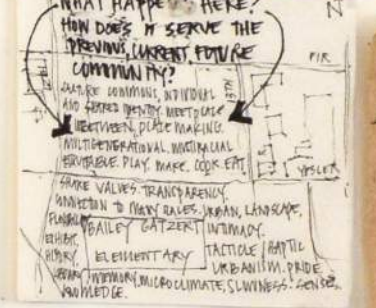
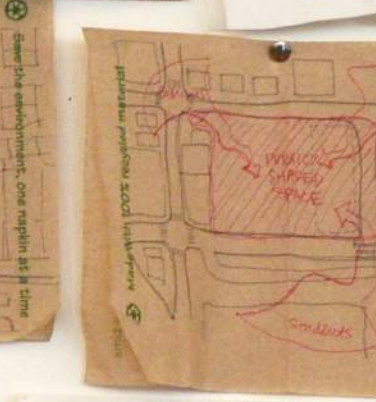
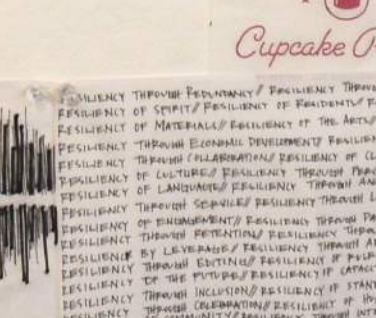
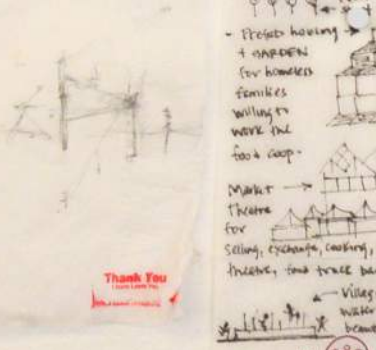
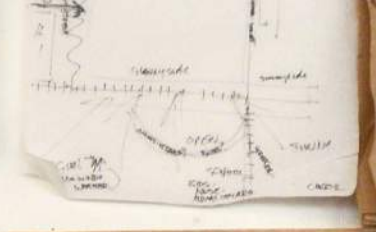
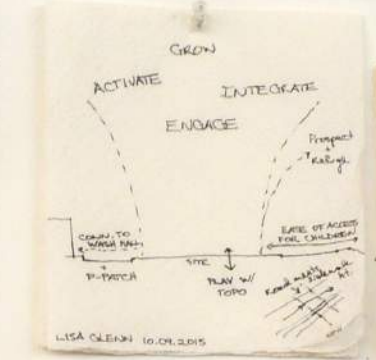
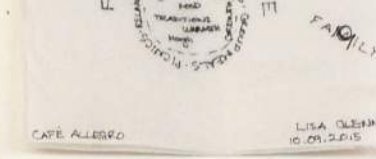
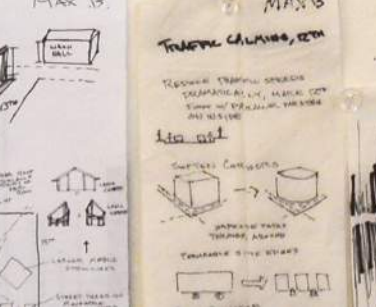
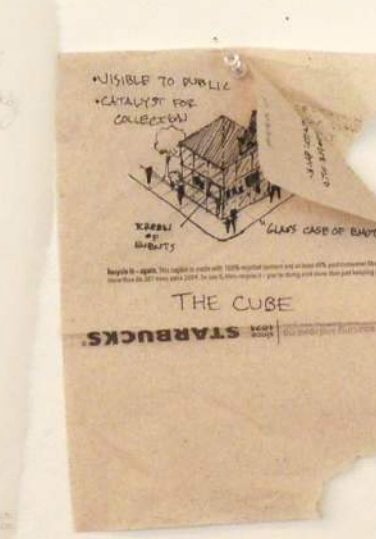
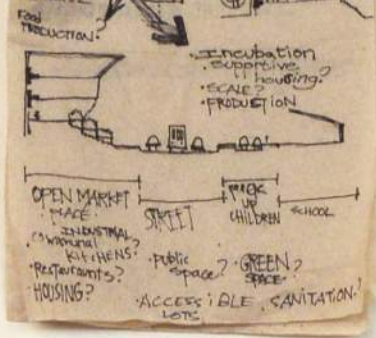
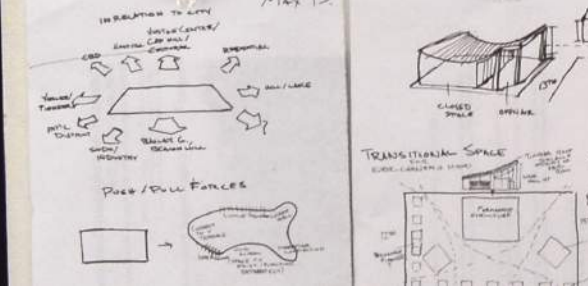
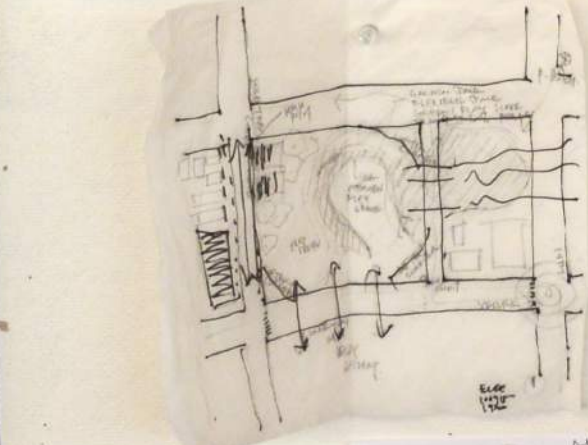
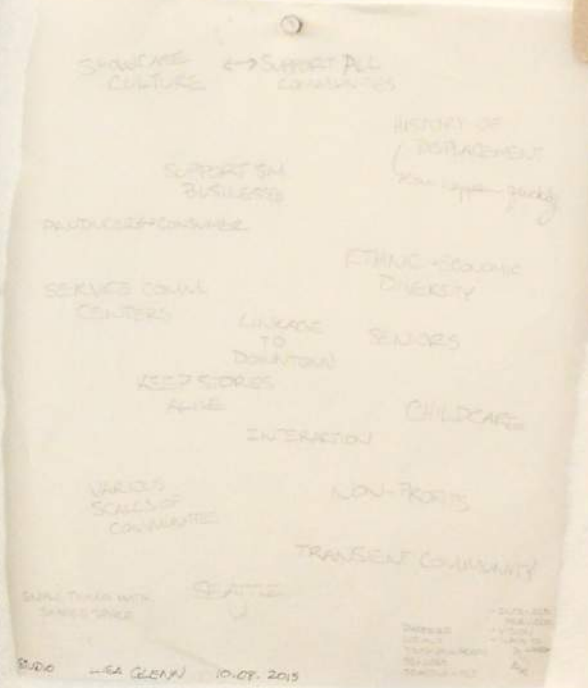
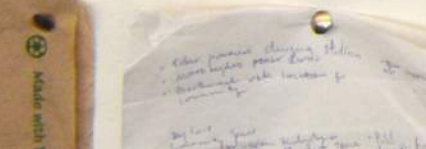
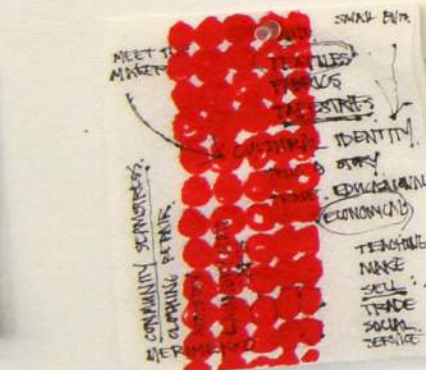
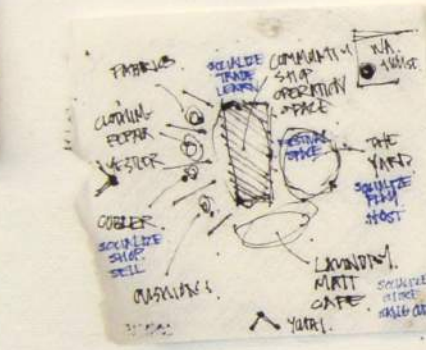
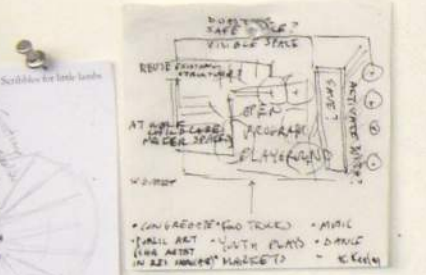
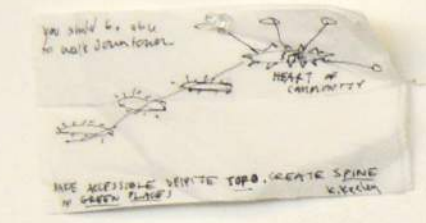

DIAGRAMS + COLLAGES

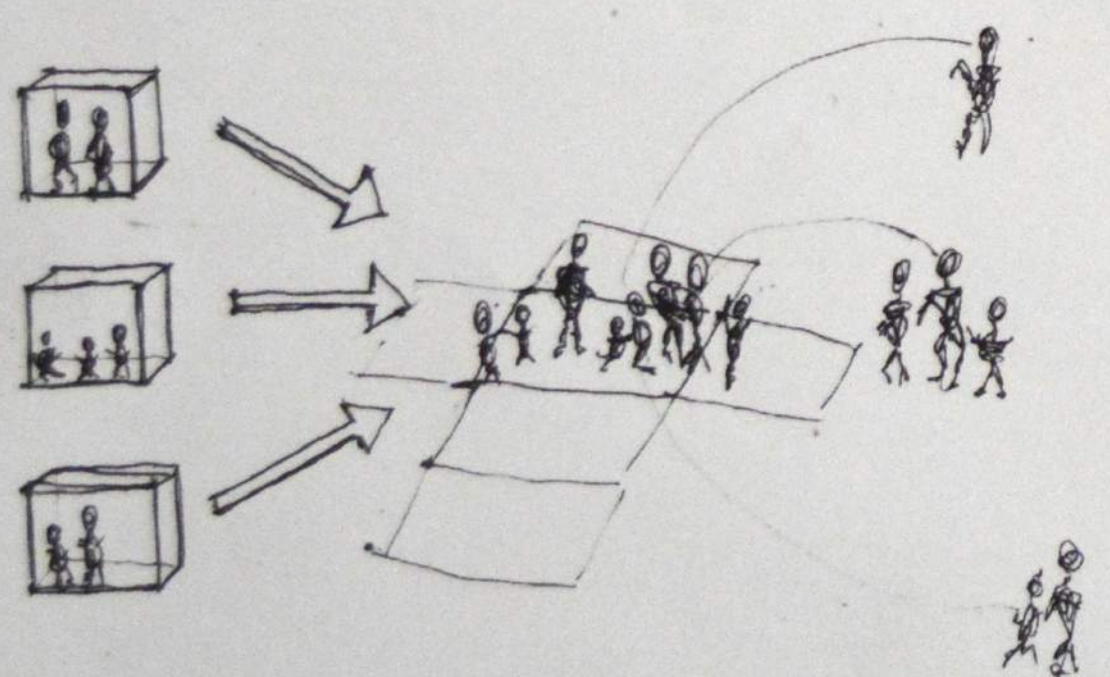
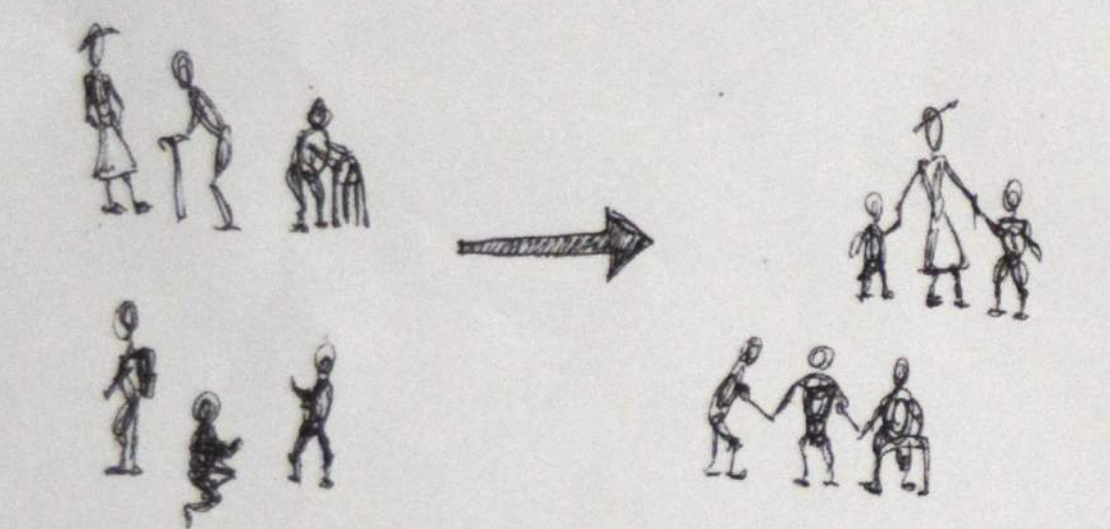
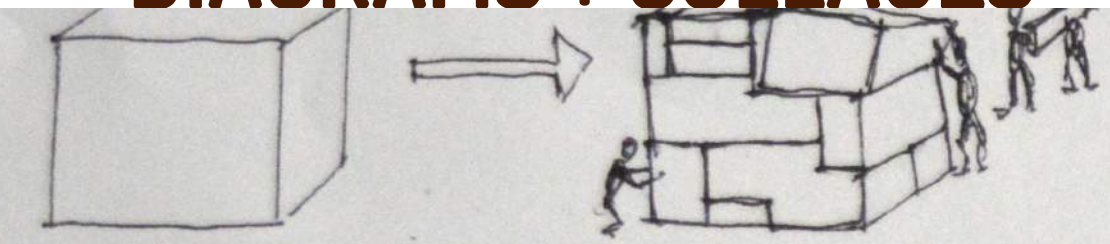

MORE PEOPLE, JUST THE RIGHT TOOLS

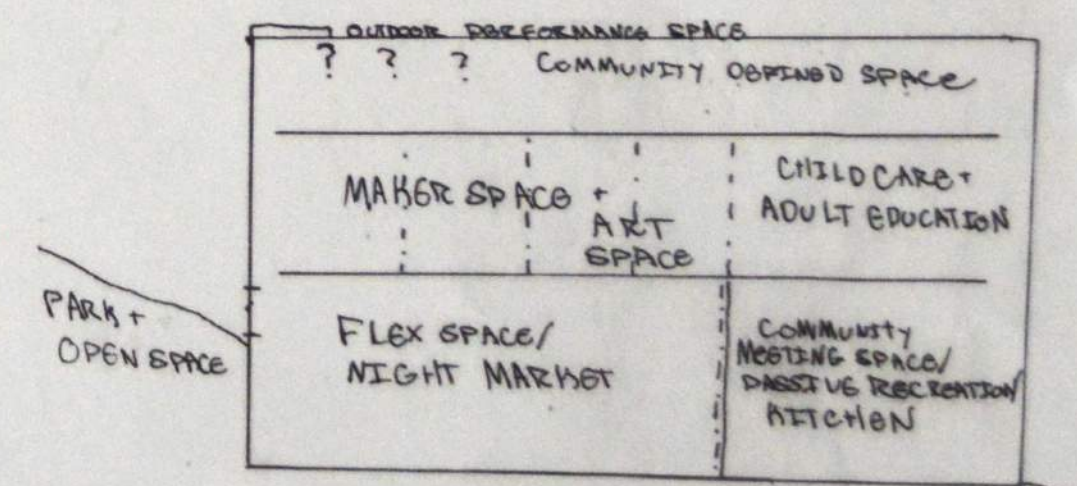
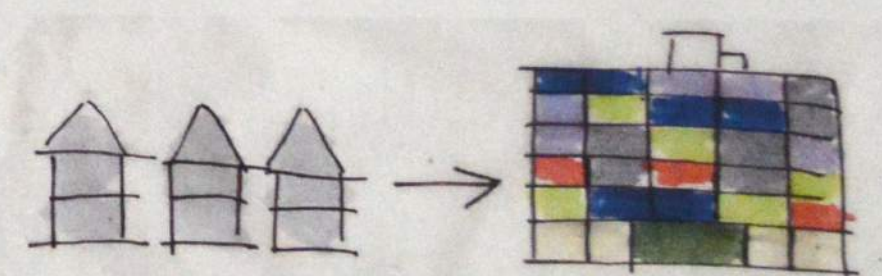
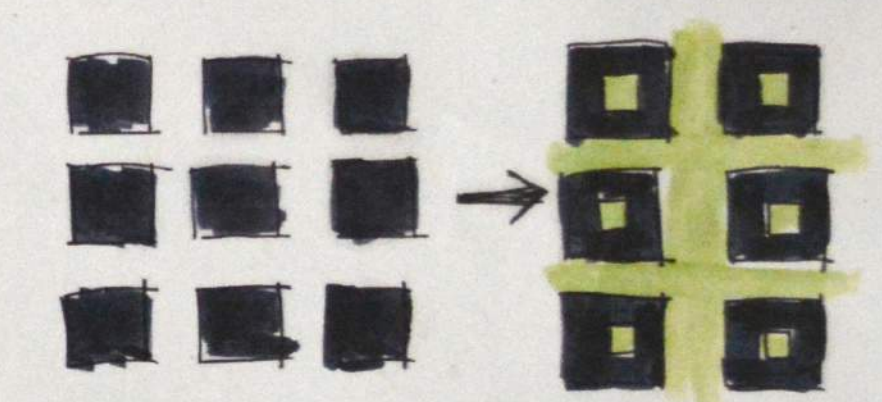
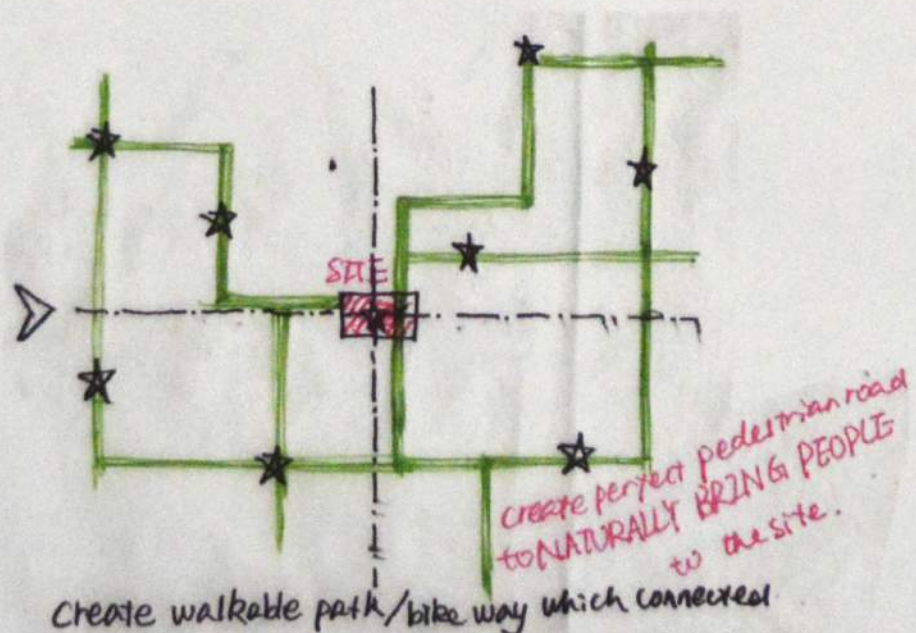
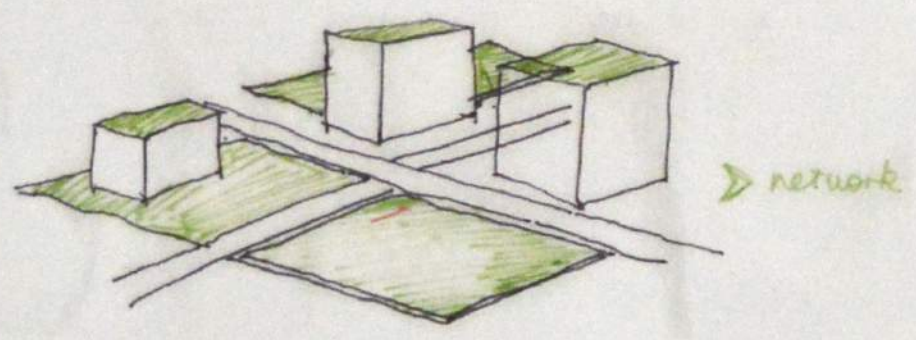
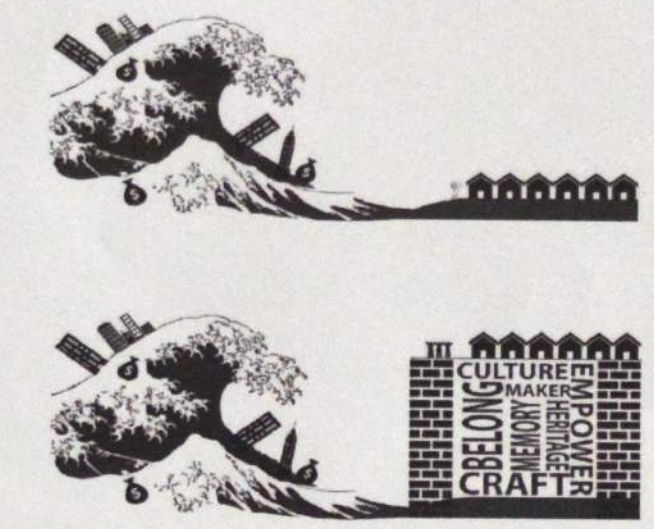

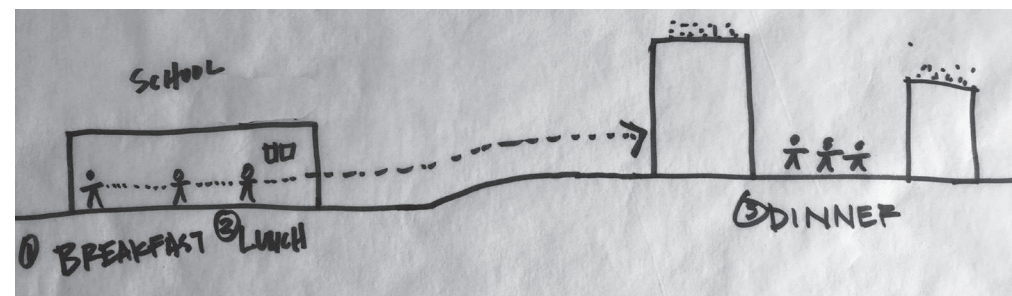
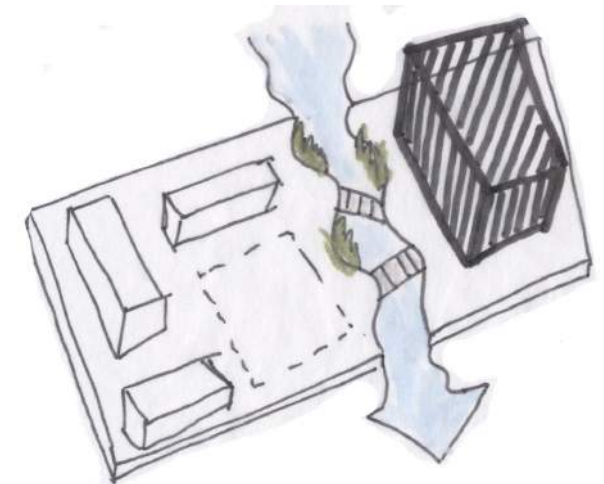
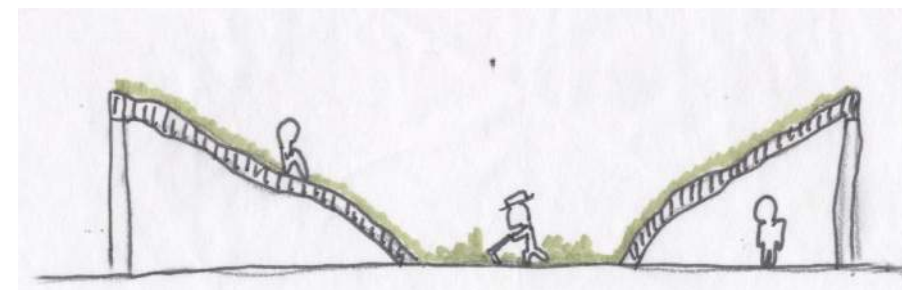
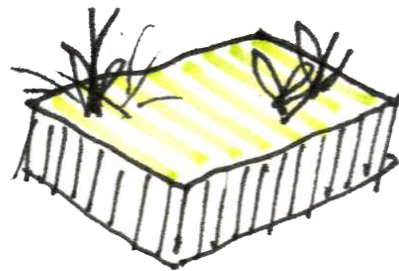
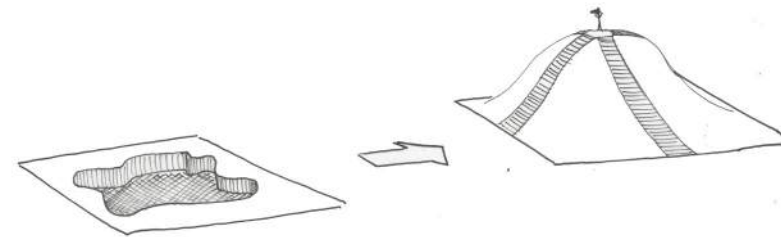
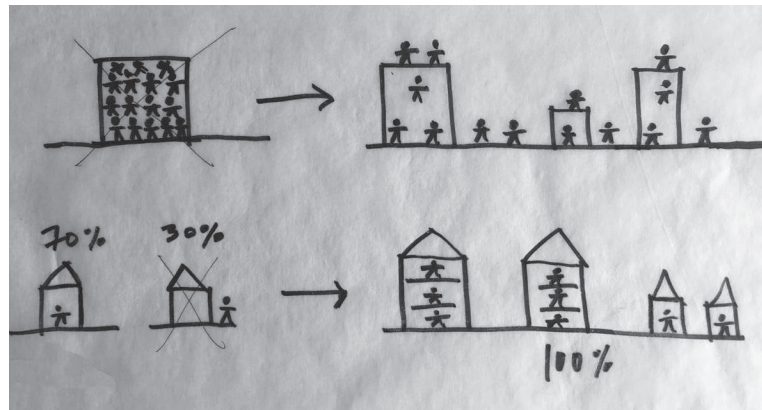
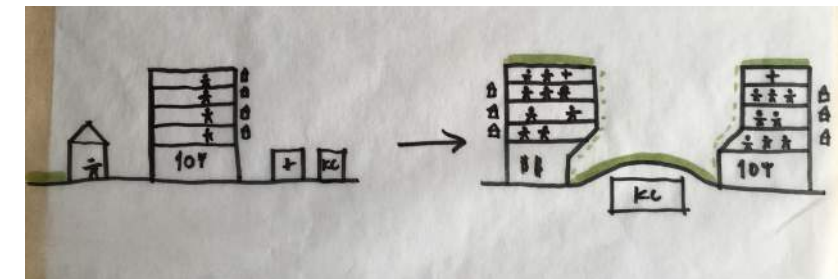
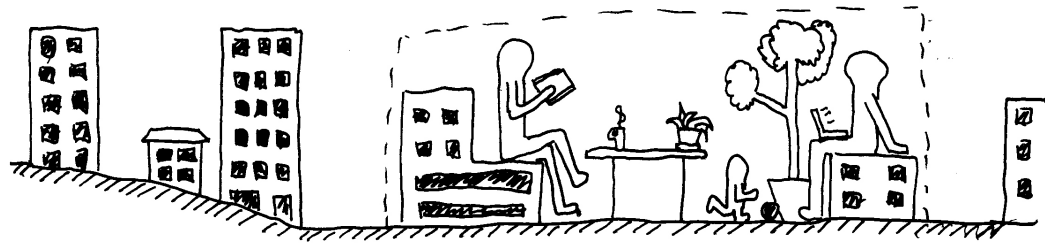
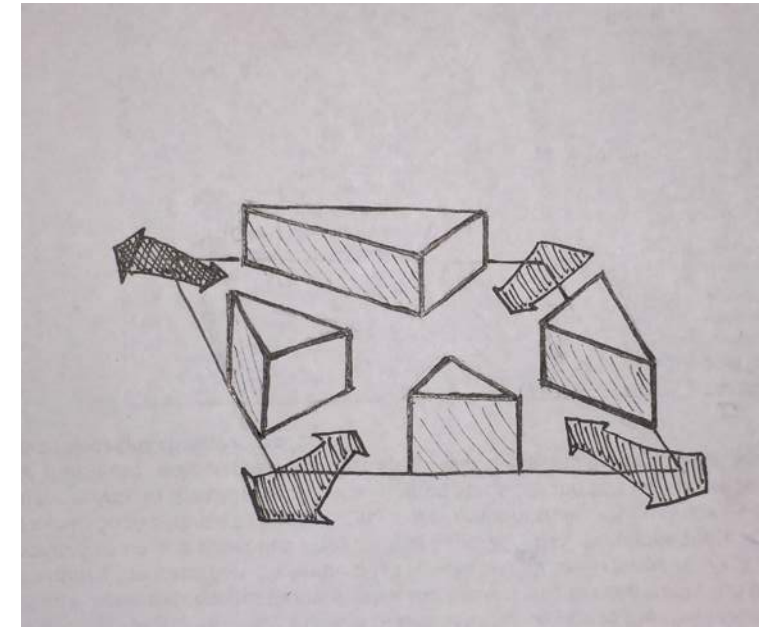
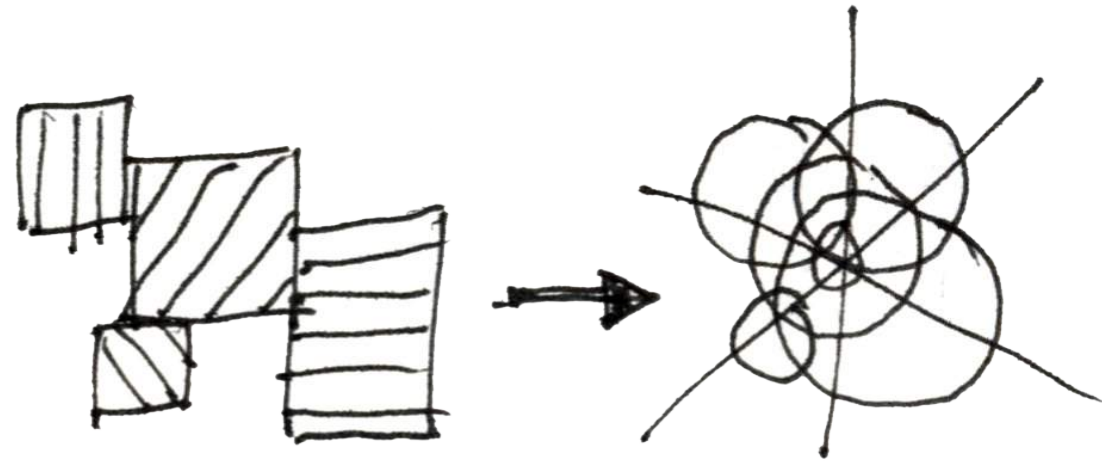
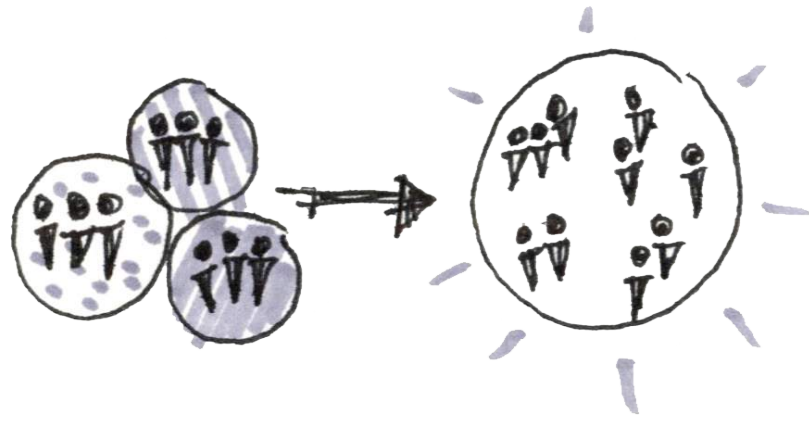

NEXUS

CYCLES

LAYERS



Cultivating Community

Climate, Culture and Craft



Buddy Kelly Mattias Max



13th Party Alley

Donny, Marta, Lisa, Stephanie, Connor

LIFE - SPACE - BUILDING



LIFE - SPACE - BUILDING

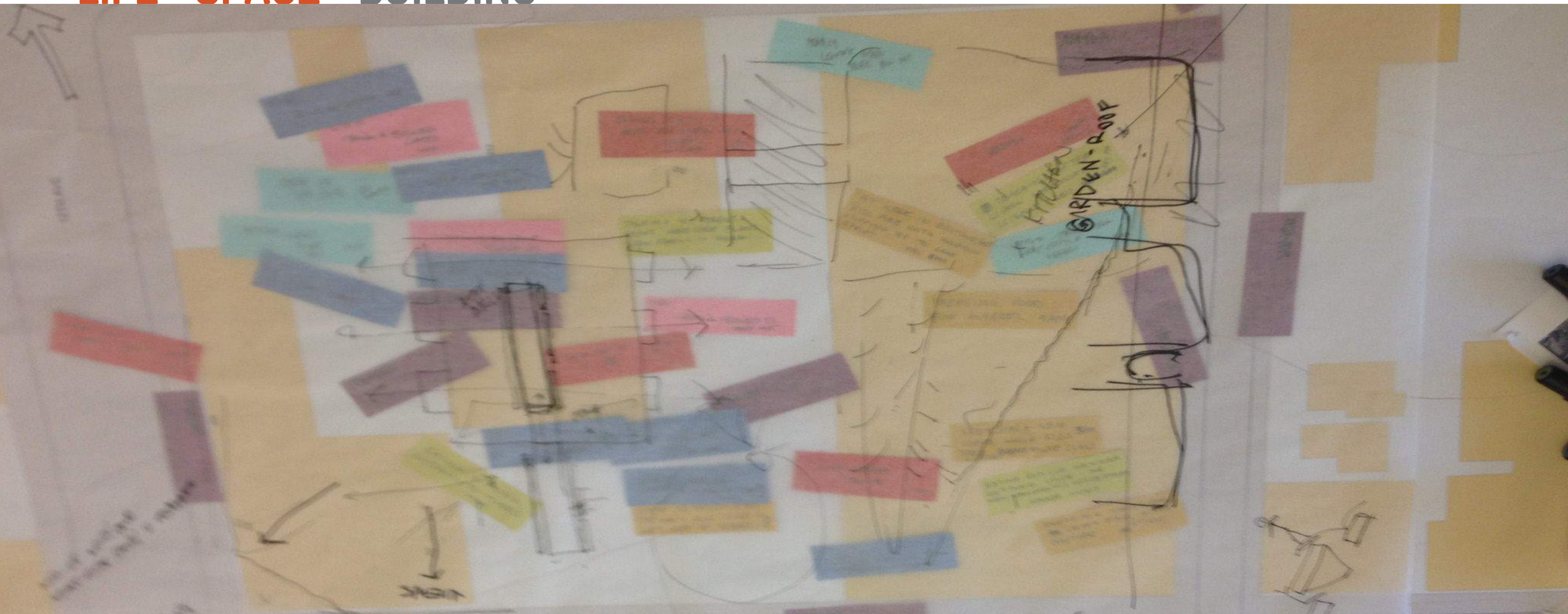

- * BAR
- * PUBIC TOILETS
- * HUB TABLE
- * COMPUTER USE
- * FOOD PREP
- * ART
- * EDUCATION
- * GARDENING
- * INFO SPACE
- * MUSIC APPRECIATION
- * MUSIC PERFORMANCE
- * PLAY
- * CONVERSATION
- * RELAX

scaled for 1"=20 feet (if plotted on 36x48)



LIFE - SPACE - BUILDING





MASSING MODELS (100 scale)

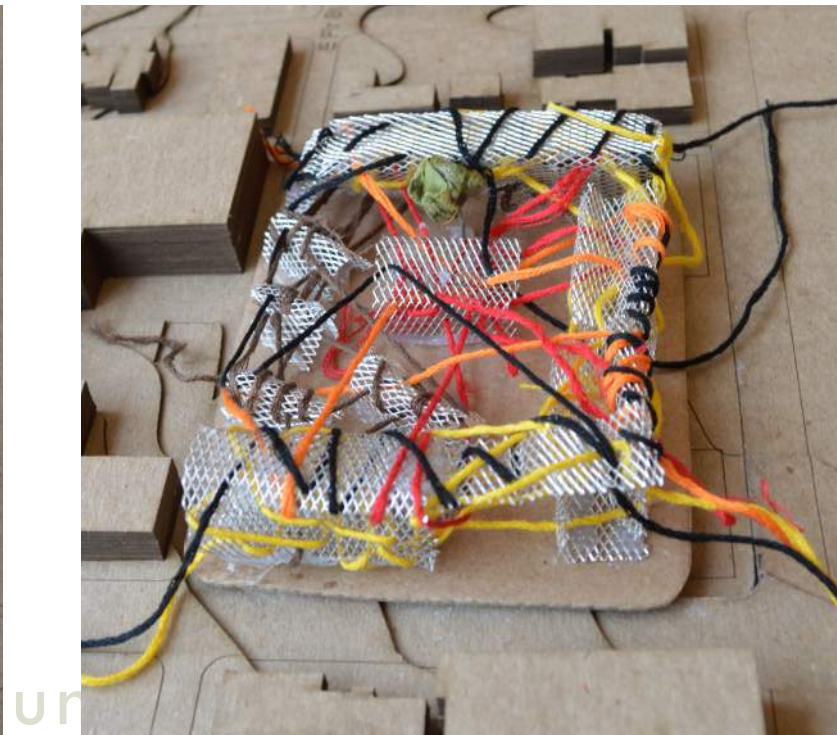
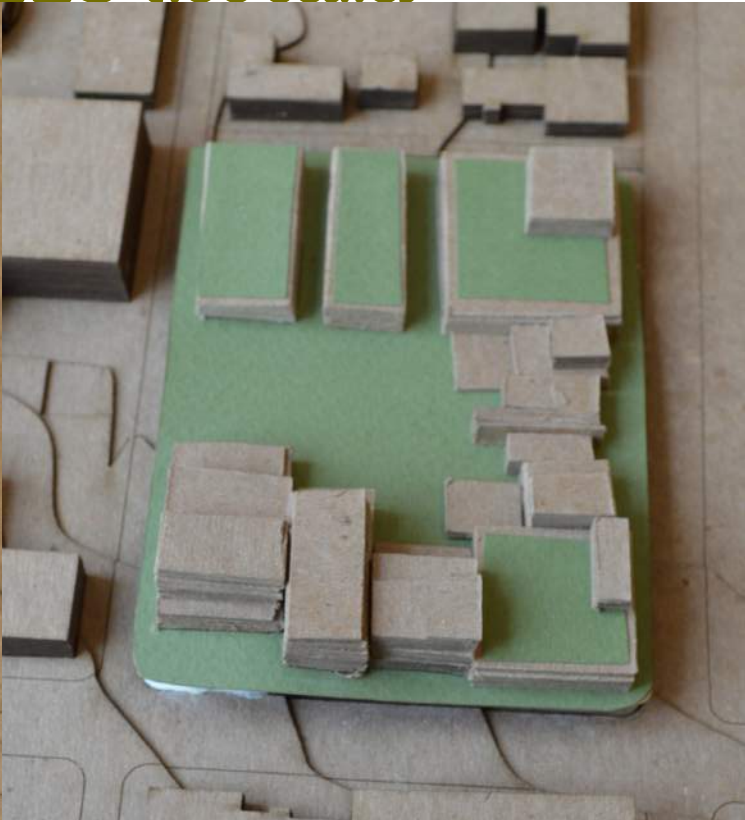

2015 Studio Schedule

September 4 - 20

Study Tour

Copenhagen + Samsø + Malmö
Helsingør

September 30

First Day of Class

Seattle
Living Community Challenge

September 30 - November 5

Copenhagen Precedents

Panel Discussion

Community Analysis

Conceptual Design

Schematic Design

November 6

(today)

Midterm Review

(here)

SCHEMATIC DESIGN

November 6

(today)

Midterm Review

(here)

TODAY'S SCHEDULE

		2-2:10	Refreshments	
			Gallery Walk	
		2:10 - 4:50	Reviews	
	2:10-2:50	2:50 - 3:30	3:30 - 4:10	4:10 - 4:50
Reviewers 1	Team A	Team B	Team C	Team D
Reviewers 2	Team D	Team C	Team B	Team A
	2:10-2:50	2:50 - 3:30	3:30 - 4:10	4:10 - 4:50
Reviewers 3	Chris - Melissa	Team E	Team F	Team G
Reviewers 4	Melissa - Chris	Team F	Team G	Team E
		4:50 - 5:00	Wrap up	

An aerial photograph of a lush rooftop garden. A central glass pavilion with a white metal roof and dark frame is the focal point, where several people are gathered. A paved path leads from the pavilion through various raised garden beds filled with diverse plants, including leafy greens and flowers. String lights are strung across the garden. In the background, a building with a corrugated metal roof and a brick wall with vertical slats are visible.

Cultivating the Community Commons

Climate, Culture, Craft
Scanl | Design Master Studio 2015